

REVISIONS		
REV. NO.	DESCRIPTION	DATE

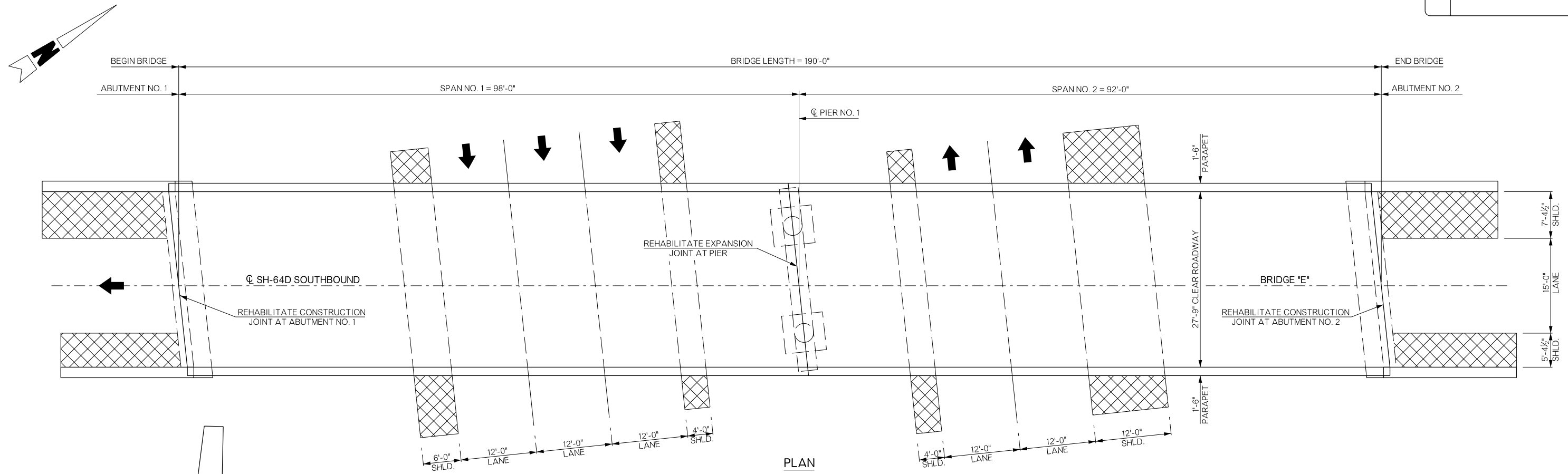

PLAN

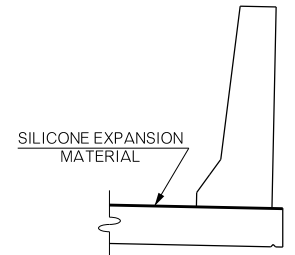

REHABILITATED EXPANSION JOINT AT PARAPET

NOTE: FOR EXPANSION JOINT, PLACE SILICONE EXPANSION MATERIAL CONTINUOUSLY ALONG THE JOINT TO THE EDGE OF THE DECK.

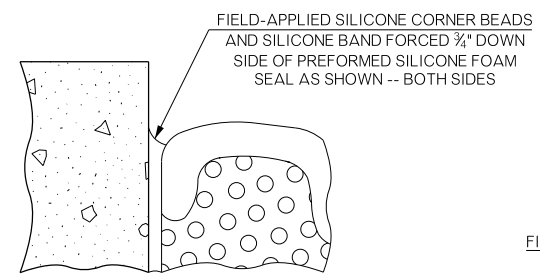

DETAIL 'A'

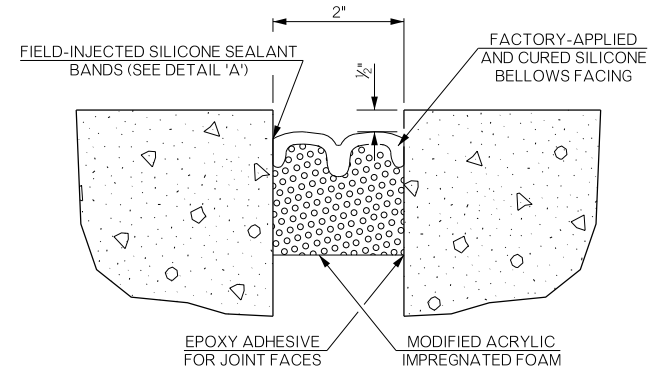

REHABILITATED CONSTRUCTION JOINTS AT ABUTMENTS

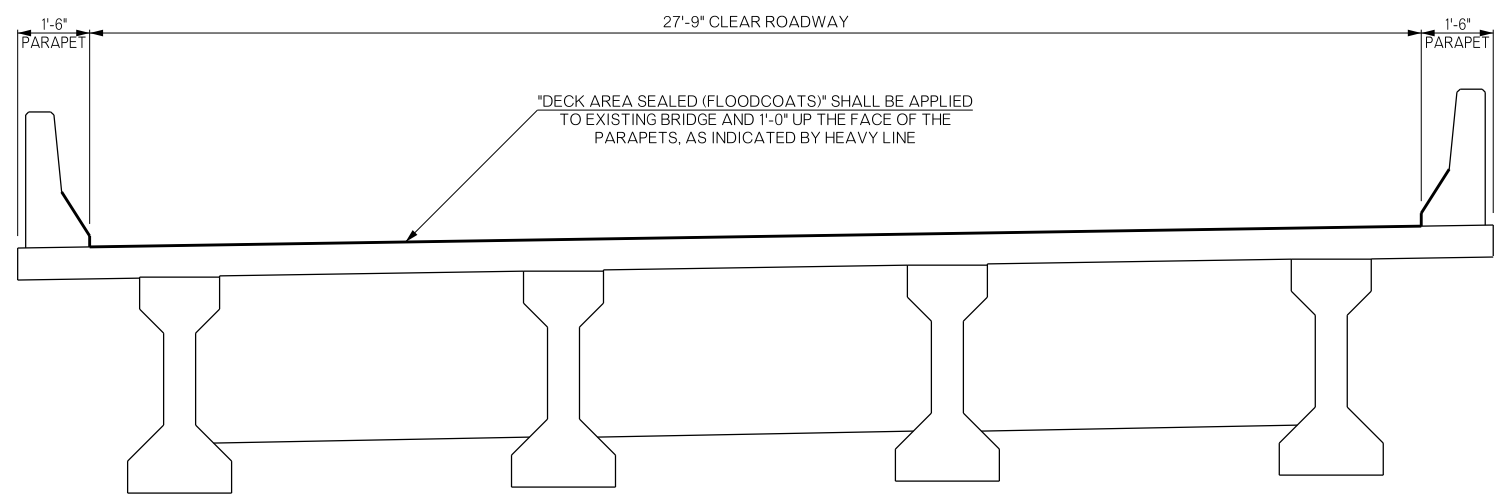

TYPICAL SECTION

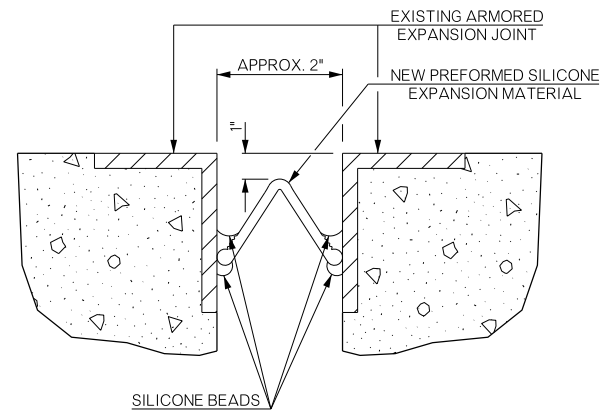

REHABILITATED EXPANSION JOINT AT PIER

BRIDGE "E" SH-64D SOUTHBOUND OVER US-64	SEQUOYAH COUNTY	Design	N/A	N/A
GENERAL PLAN, TYPICAL SECTION, AND DETAILS OF JOINT REHABILITATION (BRIDGE "E")		Detail	DAN	3/16
		Check	TEE	6/16
STATE OF OKLAHOMA		Squad	HENSLLEY	
DEPARTMENT OF TRANSPORTATION		Engr:	DEFRANCO	
JOB/PIECE NO. 31694(04)		SHEET NO.	B012	